

# ENCLOSURES with THREADED LID for MEASURING and CONTROL DEVICES and SYSTEMS

series  
**CCL**

Protection	Gas	Zone	1-2	II2G	Ex d IIC T6÷T4 Gb
	Dust		21-22	II2D	Ex tb IIIC T85°C÷T135°C Db

Degree of Protection	IP66/67
----------------------	---------

Amb. Temp.	Standard		-20°C		+40°C
	Extended		-20°C		+80°C

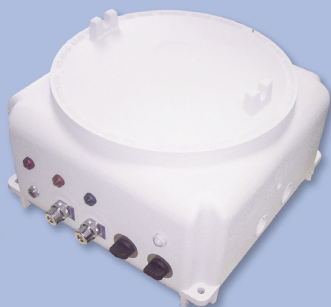

Entries Threading	NPT
	Metric

Material	Aluminum Light Alloy
----------	----------------------

Painting	external epoxy RAL 7000
----------	-------------------------

Standards and Certificates

	Directive 2014/34/EU (ATEX)
	EN 60079 - 0 • EN 60079 - 1 EN 60079 - 11 • EN 60079 - 13
	CE IMQ 10 ATEX 003
	U IMQ 10 ATEX 004U

- Ideal to interconnect the wires and to accommodate a vast variety of equipment and instruments.
- Internal anti-condense painting RAL 2004.
- Certificated either for the version complete with electrical apparatus or empty as an Ex component.

Options	- Various RAL colors.	- Accessories see page B28.	- External units (signaling units, pushbuttons, etc.)
	- Anti-corrosion technology: ALUMINOX.	- Apparatus to be housed: see page B30.	

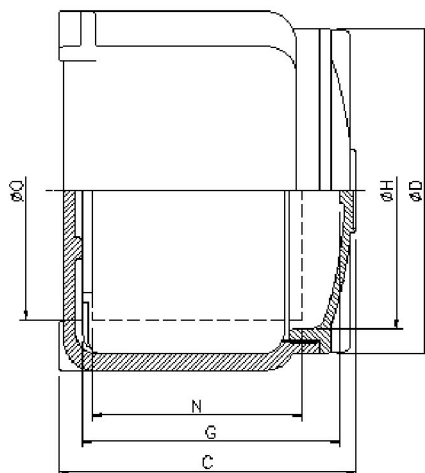
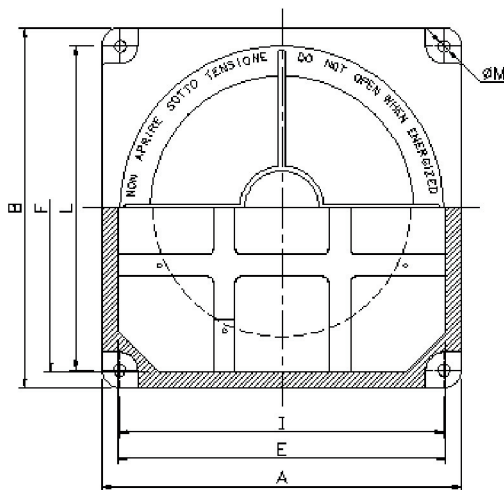

## NOTES

For enclosure cable entries layout see page B27.

For internal apparatus mounting plates see page B28.

For maximum dissipation power see page B29.

In presence of Intrinsically Safe apparatus see guidelines on page B30.

Type	Size	External Dimensions (mm)				Internal Dimensions (mm)				Mounting Template (mm)			Electrical Apparatus (mm)		Weight (kg)
		A	B	C	ØD	E	F	G	ØH	I	L	ØM	N	ØO	
CCL	0	150	150	110	130	128	128	94	103	130	130	7	80	98	2.6
CCL	1	165	165	120	145	143	143	104	118	145	145	7	90	110	3.5
CCL	2	190	190	150	166	164	164	131	135	172	172	9	110	128	5.0
CCL	3	230	230	170	200	204	204	145	163	208	208	9	130	152	8.0
CCL	4	270	270	205	240	242	242	177	203	245	245	11	145	190	12.0
CCL	5	300	300	245	270	272	272	212	228	270	270	11	175	215	15.0
CCL	6	380	380	280	350	350	350	238	290	345	345	12	190	300	25.0
CCL	7	440	440	323	410	416	416	266	350	405	405	12	226	380	38.0
CCL	8	520	520	340	480	482	482	272	416	480	480	14	254	435	52.0

## Example: CCL 3 - Mod. KIU3

Order Coding

Type	Size	Type of apparatus housed in the enclosure	Presence of control and/or signalling units	Units Size
CCL	3	K = Electrical apparatus non I.S. KI = presence of I.S. electrical apparatus	U	1: up to 1/2" - M20 2: up to 3/4" - M25 3: up to 1"

# ENCLOSURES with THREADED LID and EXTENSION for MEASURING and CONTROL DEVICES and SYSTEMS

series  
**CCL**

Protection	Gas	Zone	1-2	II2G	Ex d IIC T6÷T4 Gb
	Dust	Zone	21-22	II2D	Ex tb IIIC T85°C÷T135°C Db

Degree of Protection	IP66/67
----------------------	---------

Amb. Temp.	Standard	Extended	-20°C	+40°C
			-20°C	+80°C



Entries Threading	NPT
	Metric

Material	Aluminum Light Alloy
----------	----------------------

Painting	external epoxy RAL 7000
----------	-------------------------

**Standards and Certificates**



Directive 2014/34/EU (ATEX)	
EN 60079 - 0 • EN 60079 - 1 EN 60079 - 11 • EN 60079 - 31	
CE	IMQ 10 ATEX 003
U	IMQ 10 ATEX 004U

- Ideal to interconnect the wires and to accommodate a vast variety of equipment and instruments.
- Internal anti-condense painting RAL 2004.
- Standard or extended depth by adding one of the extensions (short or long) to accommodate larger instruments.
- Certificated either for the version complete with electrical apparatus or empty as an Ex component.

<b>Options</b>	- Various RAL paints	- Accessories see page B28	- External units (signaling units, pushbuttons, etc.)
	- Anti-corrosion technology: ALUMINOX	- Apparatus to be housed: see page B30.	

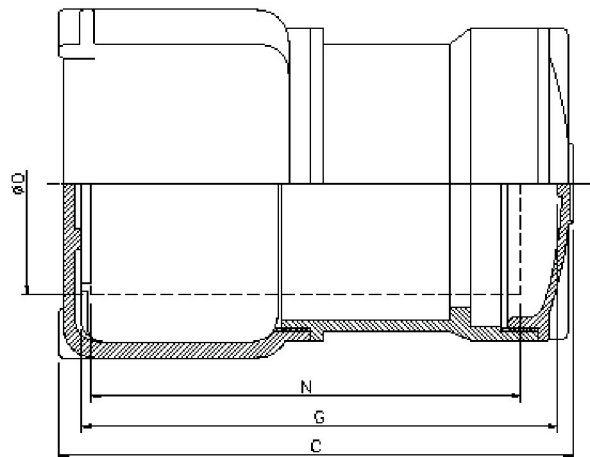
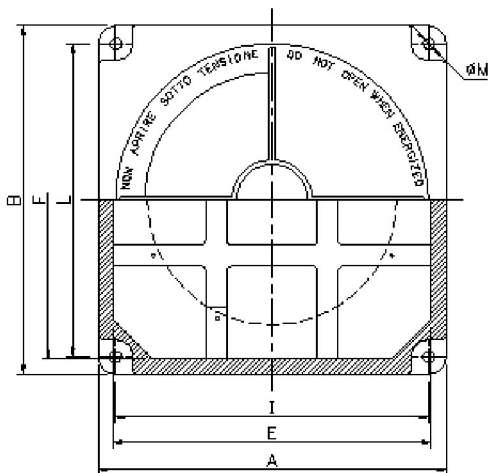

## NOTES

(°) Data refer to enclosures with short extension and long extension respectively.

For enclosure cable entries layout see page B27.

For internal apparatus mounting plates see page B28.

For maximum dissipable power see page B29.

In presence of Intrinsically Safe apparatus see guidelines on page B30.

Type	Size	External Dimensions (mm)				Internal Dimensions (mm)				Mounting Template (mm)			Electrical apparatus (mm)		Weight (kg) (°)
		A	B	C (°)	ØD	E	F	G (°)	ØH	I	L	ØM	N (°)	ØO	
CCL	0	150	150	172 - 202	130	128	128	156 - 186	103	130	130	7	142 - 172	98	2.9 - 3.2
CCL	1	165	165	180 - 220	145	143	143	164 - 204	118	145	145	7	150 - 190	110	3.8 - 4.2
CCL	2	190	190	243 - 293	166	164	164	224 - 274	135	172	172	9	203 - 253	128	6.4 - 6.7
CCL	3	230	230	259 - 334	200	204	204	234 - 309	163	208	208	9	219 - 294	152	10.1 - 11.0
CCL	4	270	270	308 - 383	240	242	242	280 - 355	203	245	245	11	248 - 323	190	15.0 - 16.4
CCL	5	300	300	358 - 448	270	272	272	325 - 415	228	270	270	11	288 - 378	215	18.7 - 20.6

## Example: CCL 1/164 - Mod. KIU3

<b>Order Coding</b>	Type	Size	Internal depth G (with extension only)	Type of apparatus housed within the enclosure	Presence of control and/or signalling units	Units Size
	CCL	1				
	160	KI = presence of I.S. electrical apparatus	U	3: up to 1"		