

## CONTACT ELEMENTS

series  
RX - RS

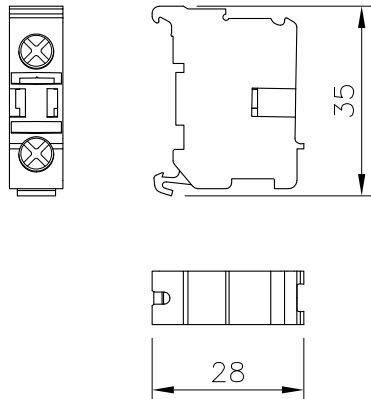

### CONTACT ELEMENTS TECHNICAL DATA:

- Nominal current :  $I_{th} = 10 \text{ A}$
- Nominal Isolation Voltage :  $U_i = 690 \text{ V}$
- Dielectric strength (minimum) : 2500 V (1 minute)
- Short circuit protection  $U_e < 500 \text{ Vac}$  : 10 A type gL/gG cartridge fuse
- Terminals ID : according to EN/IEC 60947-1
- Screw type joining terminals with captive clamp
- Wire capacity : #18÷12 AWG (0.75÷2.5 mm<sup>2</sup>) Max. (2) #14 AWG or (1) #12 AWG
- Recommended tightening torque on screw terminals : 0,7÷0,9 Nm
- Contact durability per EN 60947-5-1 (Annex C) : 10 000 000 cycles

	AC15 - A600						DC13 - Q600				
Voltage (V)	120	240	380	480	500	600	125	250	400	500	600
Current (A)	6	3	1,9	1,5	1,4	1,2	0,55	0,27	0,15	0,13	0,10
$I_{th}$ (A)	10 A						2,5 A				

## LED MODULES

series  
RX - RS

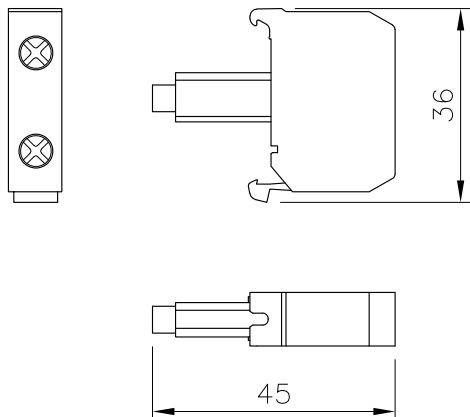

### LED MODULES TECHNICAL DATA:

- Nominal current :  $I_{th} = 10 \text{ A}$
- Nominal Isolation Voltage :  $U_i = 690 \text{ V}$
- Dielectric strength (minimum) : 2500 V (1 minute)
- Short circuit protection  $U_e < 500 \text{ Vac}$  : 10 A type gL/gG cartridge fuse
- Terminals ID : according to EN/IEC 60947-1
- Screw type joining terminals with captive clamp
- Wire capacity : #18÷12 AWG (0.75÷2.5 mm<sup>2</sup>) Max. (2) #14 AWG or (1) #12 AWG
- Recommended tightening torque on screw terminals : 0,7÷0,9 Nm

LED	24 V	120 V	240 V
Voltage (V)	10 ÷ 29	102 ÷ 132	204 ÷ 264
Current (mA)	30	6	6
Frequency (Hz)	50/60	50/60	50/60

LED COLOR	GREEN	RED	WHITE
Dominant Wavelength	525 nm	629 nm	---
Luminous Intensity	780 mcd	780 mcd	360 mcd